



COLOR KINETICS

Burst gen2

Hit the spot—and more

Product Guide

Burst gen2



Exceptional light, precise control,
consistent color, rock-solid
reliability.



In this guide:

Introducing	02
Design	04
What makes Burst gen2 different?	06
Meet the family	08
The technologies	13
Key features	14
The complete solution	16
Burst gen2 in action	18
Burst gen2 specifications	26
Burst Compact specifications	30

Lighting that hits the spot

Burst gen2 luminaires are bringing beautiful, accurate, and bright LED illumination to thousands of installations around the world. Bridges, landmarks, parks, buildings—you name it, Burst gen2 lights it.

Photography: © Psstockfoto

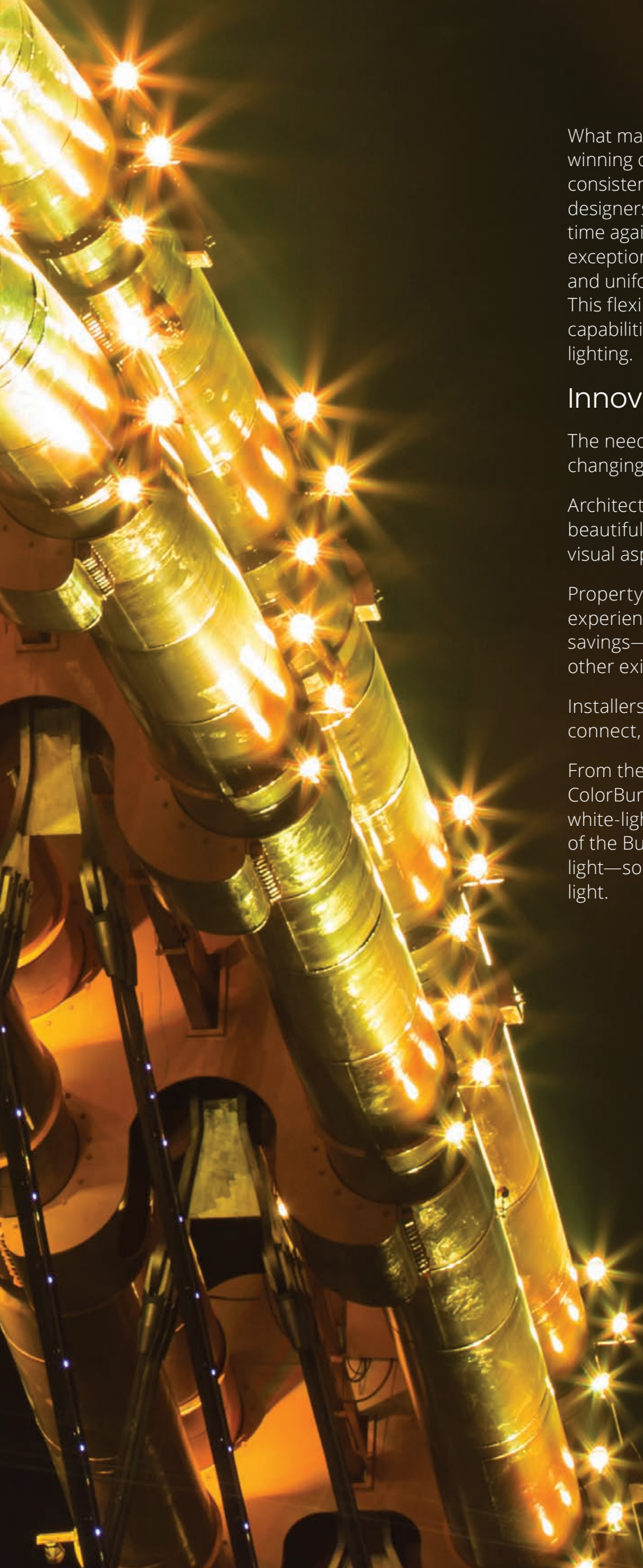

What makes the Burst gen2 family so popular? A winning combination of high-performance and consistent reliability goes a long way to explaining why designers and building owners choose it time and time again. It ticks all the boxes—high lumen output, exceptional efficiency, color consistency, beam quality and uniform light. And spot lighting is just the beginning. This flexible family of luminaires boasts a variety of capabilities, including flood, grazing and decorative lighting.

Innovation and versatility

The needs of the marketplace are broad and ever-changing, which is why Burst gen2 covers all the bases.

Architects and lighting designers: you'll get subtle yet beautiful lighting that highlights the most interesting visual aspects of your building.

Property owners: Get the attention you need while experiencing higher efficiency and even higher energy savings—not to mention complete integration with other existing luminaires and systems.

Installers and contractors: Burst gen2 is easy to mount, connect, and control.

From the strong color and tunable white light of ColorBurst IntelliHue Powercore to the consistent white-light of eW Burst Powercore gen2, each member of the Burst gen2 family delivers high-quality, brilliant light—so you can bring your most ambitious visions to light.

What makes Burst gen2 different?

New and improved

Why is Burst gen2 so different?

Photography: Signify

High output

Ongoing evolution is about pushing boundaries. When it comes to output, we're going higher and higher with each generation of the Burst family. ColorBurst Powercore gen 2 provides high lumen output in full color, while eW Burst Powercore gen2 delivers a performance boost of almost 60% compared to gen1.

Four-channel options

ColorBurst Powercore gen2 luminaires provide multiple four-channel options: IntelliHue, RGBW, and RGBA.

Bright white, clear color

Clean, bright white light and stunning, precision-controlled color light—ColorBurst IntelliHue Powercore luminaires give you the best of both worlds.

High efficiency

Burst gen2 luminaires make sure there's no wasted light, which means no wasted money either. Reliable performance, excellent beam quality, and unrivalled accuracy means light is delivered exactly where you need it.

Color consistency

Chromasync technology takes color consistency to the highest level of precision. Burst gen2 luminaires achieve a color variation of less than 2 MacAdam ellipses (2 SDCM).

Small and compact

ColorBurst Compact Powercore luminaires are sturdy and have a lower power output, making them perfect for smaller projects.

Customize with ease

A complete line of Color Kinetics accessories lets you adjust your solution to meet your specific needs.

A Wide Range of Choices

Burst Powercore gen2 comes in six different light options, and can be fitted with an array of accessories specifically designed for the luminaire family. So there are many options to choose from when selecting the ideal Burst gen2 for the job.

The six available light output options all offer unique qualities that can be utilized in different ways, depending on the requirements of your installation. IntelliHue is perfect for dialing in precise and consistent colors across multiple luminaires, while Essential White is the definitive choice for high-quality white light. With so many options, the choice is yours.

IntelliHue

High-quality white light, subtle pastels, and saturated colors, all with unrivalled color accuracy across the entire range of color temperatures.

RGBW

Better-quality white light as compared to RGB.

RGBA

Expanded color range of warmer tones—gold, yellow, and orange, as compared to RGB.

RGB

Standard option for intensely saturated color light.

iW (IntelliWhite)

Tunable white light in a range of color temperatures from 2700 K to 6500 K.

eW (Essential White)

White light in one of four color temperatures—2700 K, 3000 K, 3500 K, or 4000 K.

Perfect for your project

The Burst gen2 family provides a broad selection of options. All you need to do is choose the solution that’s right for you and your specific goals.

With each member of the Burst gen2 family of luminaires you’re guaranteed exceptional reliability and consistent high performance. However, each has its own unique qualities that would make it a better option for your project. How do you make the right choice? Here’s some more details to make the decision easier.

ColorBurst IntelliHue Powercore

Get tunable white light and precise color in the same luminaire



The combination of ColorBurst luminaires and innovative IntelliHue technology is a powerful one—it delivers the exceptional all-in-one lighting solution that lighting designers have been waiting for. You’ll get higher lumen output, higher CRI, and flawless color mixing.

IntelliHue brings high output & high CRI

IntelliHue luminaires expand the possible output wavelengths significantly—especially when compared with traditional RGB output. And no matter what wavelength you choose, IntelliHue delivers high illuminance.

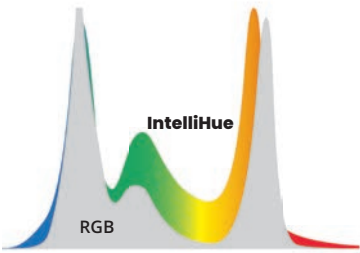

ColorBurst IntelliHue Powercore	
Power consumption	33 W
Beam angles	8°, 10°, 20°, 40°, 60°, 80°, 10° x 40°
Lumens	1,248 to 1,481

ColorBurst Powercore gen2

RGBW... RGBA... RGB—the choice is yours



This high-output luminaire performs in whichever application you ask it to, from uplighting and floodlighting to decorative and landscape lighting. The RGBW option lets you unlock the full spectrum of colors and crisp white light. RGBA adds an amber LED, providing warmer color tones. And RGB focuses on what our LEDs have always done well—that’s delivering intensely saturated color light, with the same accuracy and dependability as the other options.

eW Burst Powercore gen2

For high intensity white light



When your application requires white flooding these luminaires are the smart choice. eW Burst Powercore gen2 provides white light in four temperatures—from 2700K to 4000K. There are options for customization, too—we have additional colors available so you can choose the exact shade that matches the effect you wish to create.

	RGBW	RGBA	RGB	eW
Power Consumption	33 W			30 W
Beam Angles	8°, 10°, 20°, 40°, 60°, 80°, 10° x 40°			6°, 10°, 20°, 40°, 60°, 80°, 10° x 40°
Lumens	1,085 to 1,293	979 to 1,151	814 to 963	1,562 to 2,096

ColorBurst Compact Powercore

Beautiful color light for small scale projects



Embarking on a smaller project? The Burst Compact family has a more cost effective and appropriate solution—the ColorBurst Compact Powercore. With the same level of performance as other Burst Compact luminaires, this compact version is scaled-down and easy to install. It’s a proven solution at the right price.

iW Burst Compact Powercore

Intelligent white light in a compact form factor



This popular luminaire combines channels of warm and cool white, with exceptional results. An 8° beam angle extends light projection, with 14°, 23°, 41° and asymmetric 10°x41° spread lenses optional. The soft edge beam accentuates your buildings’ features with strong, uniform light.

eW Burst Compact Powercore

Great white light in a compact, sturdy form



Just like the iW Burst Compact Powercore, this luminaire offers several beam angles which you can customize to suit your application. With glare shields preventing spill light, and honeycomb louvers limiting the spread, you’ll get a more focused and intense beam.

	Color Compact	iW Compact	eW Compact
Power Consumption	17.5 W	17.5 W	15 W
Beam Angles	8°, 14°, 23°, 41°, 10° x 41°		
Lumens	405 to 498	609 to 709	520 to 812

Our advanced technologies raise the bar

Color Kinetics is setting new standards for consistency and accuracy by developing advanced technologies that are integrated into our luminaires, including Burst gen2.

Photography: Darius Kuzmickas

Optibin

Our LED optimization technology begins the color consistency process by grouping (or binning) LEDs by flux as well as center wavelength. This proprietary binning optimization process uses an advanced bin selection formula that exceeds industry standards for chromaticity. The result? Higher uniformity and consistency of hue and color temperature for all our luminaires. Integrated into all Burst gen2 luminaires.

IntelliHue

Our advanced approach to color mixing produces high-quality white light, subtle pastels, and fully saturated colors in the same precisely controllable luminaire. All with unrivaled color accuracy across the entire range of color temperatures. Available on Burst gen2 IntelliHue luminaires.

Chromasync

Our advanced output optimization technology controls and boosts output while ensuring color consistency.

When enabled, Chromasync ensures excellent color consistency between luminaires, without manually adjusting color points on each luminaire. And it ensures the same lumen output across all color temperatures. Integrated into all ColorBurst gen2 luminaires.

Powercore

Our patented approach to power output proves that simple is better. As well as faster, more efficient, and accurate. Powercore controls power output to luminaires directly from line voltage. It merges line voltage with control data and delivers both over a single standard cable—dramatically simplifying installation and lowering total system cost. Integrated into all Burst gen2 luminaires.

To find out how innovative technologies within our advanced luminaires can help you do more, visit www.colorkinetics.com/Learn.

Take a closer look

Housings available in
Architectural or Landscape



Bronze housing
color available
as a special

Standard
1/2 inch
NPS thread.

Safe and dry

An intelligent design prevents water pooling around the luminaire, keeping the light clear and crisp.

Ground-breaking optics

An innovative, redesigned optical system improves the quality of light from each LED, enhancing uniformity, accuracy, and efficiency.



Simplified technology

Our integrated Powercore technology controls power output efficiently and accurately. Data Enabler Pro merges line voltage with control data through a single cable. The result? Dependable power supply, quick, easy installation, and reduced system costs.

Easy customization

Black, gray, white – Burst gen2 Powercore lets you choose from three housing colors to blend seamlessly into your application. You can also add a louver, full glare shield, half glare shield, or mounting arm. Exploring new possibilities is easy with the Burst gen2 collection.

Rugged and durable

Burst gen2 luminaires are cast in heavy-duty aluminium, making them able to withstand harsh conditions. They comply with the ASTM B117 corrosion standard for more than 1,500 hours, and ANSI C136.31-2010 vibration resistance standard.

Input voltage

100 to 277 VAC, auto-ranging, 50/60 Hz via Data Enabler Pro.

Compact versions available

ColorBurst Compact combines a small footprint, focused beam, and ease of installation to give you an excellent alternative to the standard Burst gen2 range, in 3 housing colors.



Exceptional lighting takes more than a luminaire

To unlock the full potential of your Burst gen2 luminaires, you need the right components to power and control them. Color Kinetics completes your solution with:

Controllers

Our broad line of controllers brings you differing capabilities that match your specific needs, the complexity of your project, and your budget. Our controllers offer the industry-standard DMX protocol, or our proprietary, scalable KiNET protocol for Ethernet networks. Because of addressing limitations, DMX is appropriate for relatively simple installations, or for light shows in which multiple Burst gen2 luminaires operate in unison.

Because it is not subject to DMX addressing limitations, Ethernet is the preferred environment for intricate color-changing light shows. And Burst Powercore gen2 can also be used with third-party controllers.



Power/Data Supplies

We pair each Burst gen2 luminaire with the right Data Enabler Pro, delivering the power and data needed for your project, ensuring exceptional operation, and maximizing run lengths.

Monitoring and Management

Interact Landmark (formerly Philips ActiveSite) is the first-ever cloud-hosted connected lighting system for architectural LED lighting installations. Interact Landmark allows you to remotely monitor, manage, and maintain an installation site from anywhere in the world, using a secure web connection.

Enter the dragon



Photography: Biz Tequilar, Biz Tequilar Agency, partner of Onevoice

The Dragon Bridge in Da Nang, Vietnam, is an awe-inspiring structure linking the city to the airport.

More than 2,500 Color Kinetics LED luminaires team up to create an eye-catching, one-of-a-kind effect—a mesmerizing dragon soaring through the sky, glowing with vivid light. It’s become a true icon of the city, and it’s all thanks to the power and performance of Color Kinetics lighting—including more than 850 ColorBurst Powercore luminaires.

Product	ColorBurst Powercore
Details	Hundreds of ColorBurst luminaires were spaced along the 610 m (2,000 ft) bridge, highlighting each 10 m (33 ft) segment of the bridge

A personalized retail experience

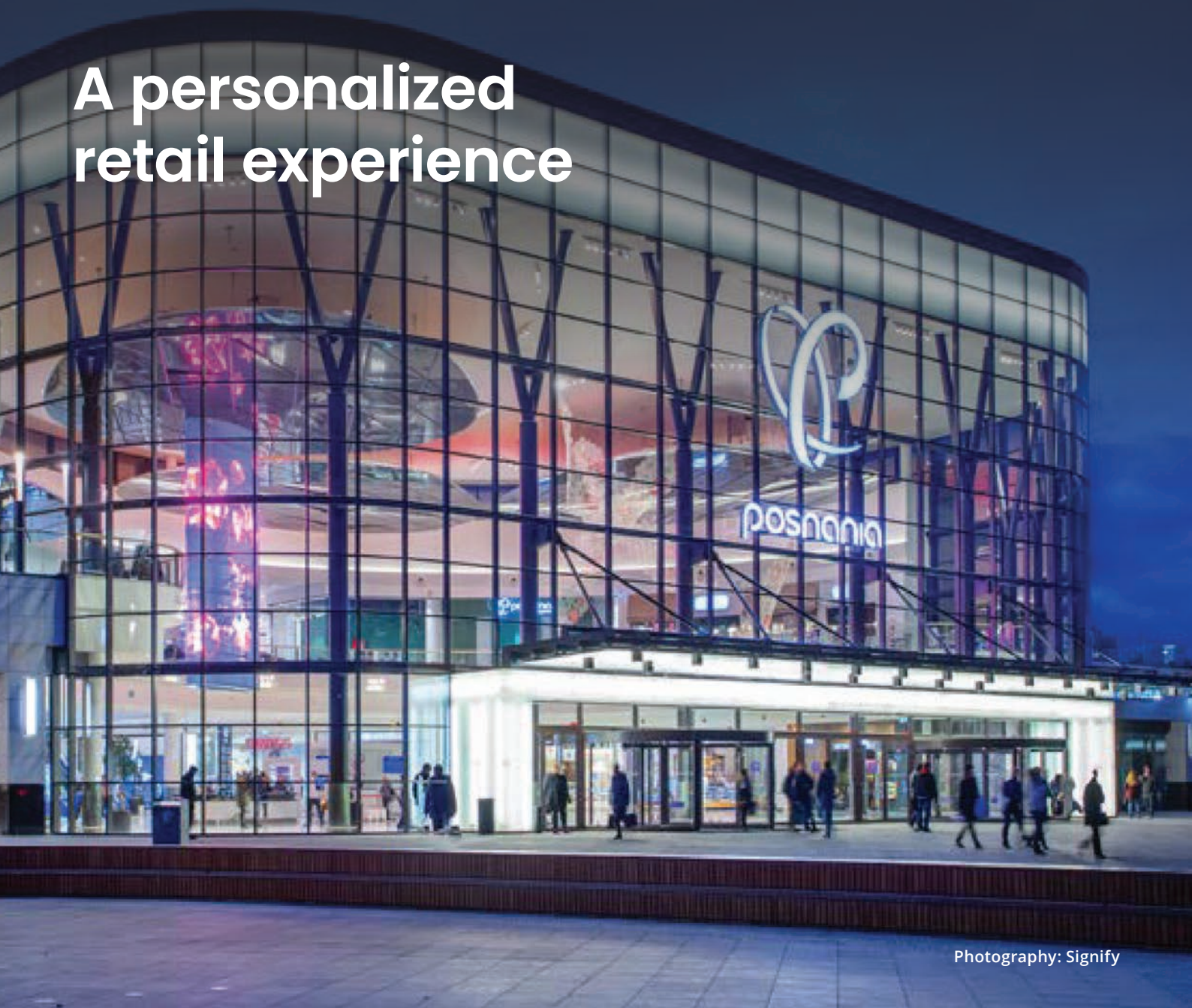

Photography: Signify

Attracting shoppers to Poland's Posnania mall.

Color Kinetics LED technology played its part in attracting more than 40,000 visitors within just four hours of the mall's grand opening. Interactive lighting helps to navigate shoppers around the building, as well as acting as an aesthetically pleasing and comforting backdrop. What's more, this was all achieved while maintaining a sustainable level of electricity consumption.

Product	ColorBurst Powercore gen2, RGBW
Details	Create lighting scenarios throughout the mall and creating emphasis on the building's architecture

Ethereal lighting works miracles



Photography: Signify

One of Europe's oldest and largest Romanesque churches gets a new lease of life.

The Saint-Gertrudis Church in Nijvel, Belgium, required a lighting solution that would provide exceptional light while requiring little maintenance. The answer was a series of eW Burst Powercore luminaires featured in the aisles, doorways, and arches of this stunning building, highlighting beautiful architectural accents throughout and creating a welcoming ambiance.

Product	eW Burst Powercore
Beam Angle	10°
Details	Various spacing to illuminate the two main entrances, aisles, arches, chancel, and works of art

A glowing tribute



Photography: Signify

The Çanakkale Martyrs' Memorial in Çanakkale, Turkey, honors the memory of the 253,000 Turkish soldiers who lost their lives during World War I.

The trees which line the pathway approaching the memorial are adorned with ColorBurst Powercore luminaires, illuminating the way to this sacred and touching tribute. The lighting is an important aspect of a beautiful yet sobering display and creates an emotional setting for visitors.

Product	ColorBurst Powercore
Beam Angle	10°x40°
Details	Luminaires located along the pathway leading to the monuments

A deserved encore for run-down theatre



Photography: Courtesy of Troxy, London

Since opening its doors in 1933, The Troxy Theatre in London, UK, had lost some of its glamour and pizzazz.

The use of Color Kinetics LED lighting has helped return The Troxy Theatre to its former glory, with ColorBurst Compact Powercore luminaires emitting a unique and brilliant blue light that washes the building's elaborate façade without overpowering the attractive features.

Product	ColorBurst Compact Powercore
Beam Angle	10°
Details	Luminaires located inside and outside this historic theater

Abandoned palace gets royal renovation



Photography: Ammar Keylani

Cairo's Baron Palace had been neglected for years and was in dire need of a makeover.

As a Hindu structure in a primarily non-Hindu city, Baron Palace's unusual and unique features had spent a long time being unappreciated. Now, the bold and beautiful building is being shown in its best light by eW Burst Powercore luminaires. Not only does the palace now bask in high-quality white light, but the switch to LED has resulted in energy savings of around 80%.

Product	eW Burst Powercore
Beam Angle	20°
Details	Various spacing to illuminate architectural details

Europe's largest living wall



Photography: Red Shift Photography

Birmingham, UK's Green Wall creates a remarkable experience for passers-by.

The Green Wall, an icon of Snow Hill Station, stretches a huge 2,000 square feet (604 square meters) and features an array of living, breathing plants. iW Burst Powercore luminaires from Color Kinetics add visual interest to the textured wall, creating a stunning shimmering effect when the sun goes down.

Product	iW Burst Powercore
Beam Angle	20°
Details	Uplighting textured panels

An elegant city hall



Photography: Red Shift Photography

Color Kinetics LED lighting adds even more sophistication to Belfast's iconic city hall.

The Belfast City Hall has dominated the Northern Irish capital's skyline since its opening in 1906, and its lawns and gardens are a popular attraction for visitors. Upgrading to LEDs has not only enhanced energy efficiency and improved aesthetics, but the clean, clear white light adds an element of importance and grandeur to a building which regularly hosts some of the city's top officials.

Product	ColorBurst Powercore
Beam Angle	10°, 20°, 10° x 40°
Details	Various spacing to illuminate architectural details

Specifications and information

Products	Mounting options	Power consumption	Lumens	Efficacy lm/W	CRI
ColorBurst IntelliHue Powercore	Architectural Landscape	33 W	1,248 to 1,481	40 to 47	–
ColorBurst Powercore gen2, RGBW			1,085 to 1,293	34 to 40	–
ColorBurst Powercore gen2, RGBA			979 to 1,151	31 to 36	–
ColorBurst Powercore gen2, RGB			814 to 963	30 to 35	–
eW Burst Powercore gen2		30 W	1,562 to 2,096	54.4 to 74.6	81 to 84

General information

Beam Angles	8° native (6° native eW) 10°, 20°, 40°, 60°, 80°, 10° x 40°
LED Channels	IntelliHue—Red/Green/Blue/Mint White RGBW—Red/Green/Blue/White RGBA—Red/Green/Blue/Amber RGB—Red/Green/Blue eW—2700 K, 3000 K, 3500 K, or 4000 K
Input Voltage	100 to 277, auto-ranging, 50/60 Hz
Housing Material	Die-cast aluminium, powder-coated finish
Lens	Clear tempered glass
Approbations	UL/cUL, FCC Class A, CE, PSE, CQC, RCM
Environment	Dry/Damp/Wet Location, IP66
Weight	Architectural—5.5 kg (12.1 lb) Landscape—3.5 kg (7.7 lb)
Dimensions	Architectural—287 x 210 x 186 mm(11.3 x 8.3 x 7.3 in) Landscape—272 x 163 x 185 mm(10.7 x 6.42 x 7.28 in)

For further information

Complete details of every family, including part numbers, installation instructions, specification sheets, .ies files, and product drawings, can be found on the respective product pages.



**ColorBurst IntelliHue
Powercore**



**ColorBurst Powercore
gen2, RGBW**

**ColorBurst Powercore
gen2, RGBA**

**ColorBurst Powercore
gen2, RGB**



**eW Burst Powercore
gen2**

Accessories

Accessory options let you customize Burst gen2. Specification Sheets and product drawings can be found on the respective product pages.

Dimensions

Burst gen2 Architectural

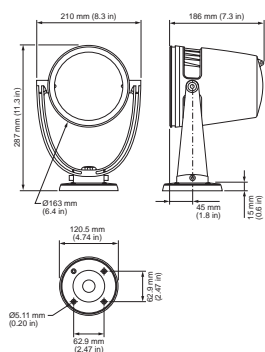

With Trim Ring

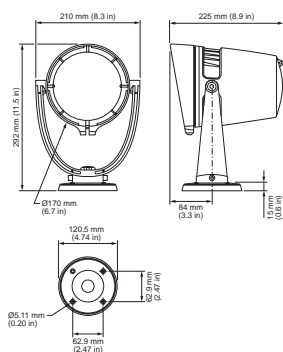

With Half Glare Shield

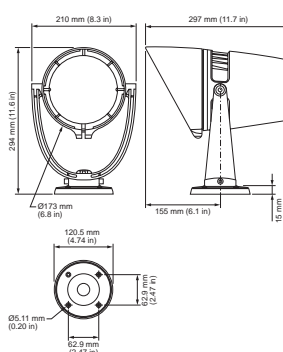

With Full Glare Shield

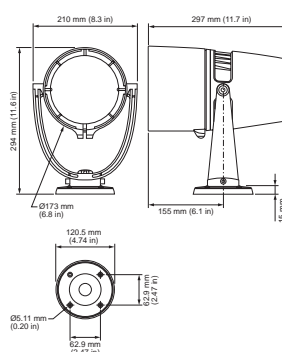

Burst gen2 Landscape

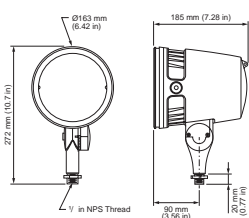

With Trim Ring

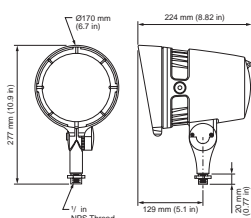

With Half Glare Shield

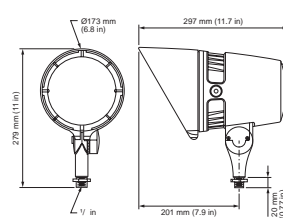

With Full Glare Shield

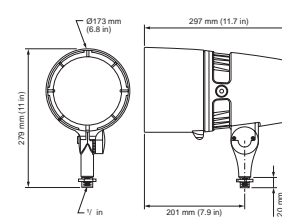

Configuration and planning

Regardless of the size and complexity of your installation, the planning time you spend up front can help streamline the installation and configuration of your luminaires. Keep these points in mind as you plan your installation:

Create a lighting design plan that identifies and locates all luminaires, Data Enabler Pro devices, and controllers. Use **Configuration Calculator** to determine how many luminaires you can install in a single run, and the maximum distances between Data Enabler Pro devices, luminaires, and controllers.

Burst Powercore gen2 luminaires operate in 8-bit mode by default. To Address luminaires, including switching between 8-bit mode and 16-bit mode, by downloading **QuickPlay Pro 2**.

Determine whether to address luminaires and configure your lighting system offline or interactively. With offline configuration, you stage and configure your system off-site, prior to installation. Offline configuration can be convenient when luminaires are to be installed in multiple locations or locations with difficult access. Interactive configuration is typically performed by an experienced technician, after luminaires have been installed. The interactive method can save time, since you only connect and test your luminaires once.

Accessories

	Item Number	Item 12NC
10° Spread Lens	120-000189-18	912400135371
20° Spread Lens	120-000189-12	912400133442
40° Spread Lens	120-000189-13	912400133443
60° Spread Lens	120-000189-14	912400133444
80° Spread Lens	120-000189-15	912400133445
10°x40° Spread Lens	120-000189-16	912400133446
Trim Ring gen2, Black	120-000189-21	912400135450
Trim Ring gen2, Gray	120-000189-20	912400135449
Trim Ring gen2, White	120-000189-22	912400135451
Half Glare Shield gen2, Black	120-000189-25	912400135454
Half Glare Shield gen2, Gray	120-000189-24	912400135453
Half Glare Shield gen2, White	120-000189-26	912400135455
Full Glare Shield gen2, Black	120-000189-29	912400135458
Full Glare Shield gen2, Gray	120-000189-28	912400135457
Full Glare Shield gen2, White	120-000189-30	912400135459
Louver	120-000189-17	912400133447
Mounting Arm, Short, Black	120-000201-00	912400135840
Mounting Arm, Short, Gray	120-000201-03	912400135843
Mounting Arm, Short, White	120-000201-06	912400135846
Mounting Arm, Medium, Black	120-000201-01	912400135841
Mounting Arm, Medium, Gray	120-000201-04	912400135844
Mounting Arm, Medium, White	120-000201-07	912400135847
Mounting Arm, Long, Black	120-000201-02	912400135842
Mounting Arm, Long, Gray	120-000201-05	912400135845
Mounting Arm, Long, White	120-000201-08	912400135848
Wiring Compartment, 4 in diameter, Black, CE (cover not included)	106-000011-40	910503703275
Wiring Compartment, 4 in diameter, Gray, CE (cover not included)	106-000011-42	910503703277
Wiring Compartment, 4 in diameter, White, CE (cover not included)	106-000011-41	910503703276
Wiring Compartment, 4 in diameter, Black, UL (cover not included)	106-000011-30	910503704147
Wiring Compartment, 4 in diameter, Gray, UL (cover not included)	106-000011-32	910503704149
Wiring Compartment, 4 in diameter, White, UL (cover not included)	106-000011-31	910503704148
Power Supplies		
Data Enabler Pro, 3/4 in / 1/2 in NPT (U.S. trade size conduit)	106-000004-00	910503701210
Data Enabler Pro, PG21/PG13 (metric size conduit)	106-000004-01	910503701211

Specifications and information

Products	Mounting options	Power consumption	Lumens	Efficacy lm/W	CRI
ColorBurst Compact Powercore	Architectural Landscape	17.5 W	405 to 498	19.9 to 24.4	–
iW Burst Compact Powercore		17.5 W	609 to 709	27.9 to 32.5	–
eW Burst Compact Powercore		15 W	520 to 812	34.8 to 53.8	83 (2700 K) 81 (4000 K)

General information

Beam Angles	8° native 14°, 23°, 41°, 10° x 41°
LED Channels	RGB—Red/Green/Blue iW—2700 K to 6500 K eW—2700 K or 4000 K
Input Voltage	100 to 277, auto-ranging, 50/60 Hz (eW Burst Compact) 100 to 240, auto-ranging, 50/60 Hz (ColorBurst Compact and iW Burst Compact)
Housing Material	Die-cast aluminium, powder-coated finish
Lens	Clear tempered glass
Approbations	UL/cUL, FCC Class A, CE, PSE, CQC, C-Tick, SAA
Environment	Dry/Damp/Wet Location, IP66
Weight	Architectural—3.9 kg (8.7 lb) Landscape—2 kg (4.4 lb)
Dimensions	Architectural—250 x 114 x 178 mm (9.85 x 4.5 x 7 in) Landscape—205 x 114 x 178 mm (8.06 x 4.5 x 7 in)

For further information

Complete details of every family, including part numbers, installation instructions, specification sheets, .ies files, and product drawings, can be found on the respective product pages.



ColorBurst Compact Powercore



iW Burst Compact Powercore



eW Burst Compact Powercore

Accessories

Accessory options let you customize Burst Compact. Specification Sheets and product drawings can be found on the respective product pages.

Dimensions

Burst Compact Architectural

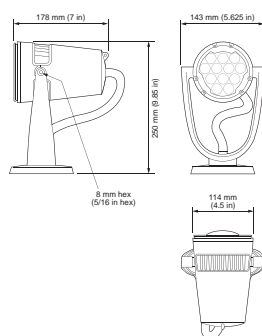

Burst Compact Landscape

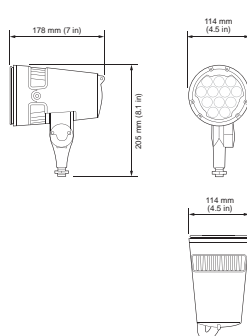

Configuration and planning

Regardless of the size and complexity of your installation, the planning time you spend up front can help streamline the installation and configuration of your luminaires. Keep these points in mind as you plan your installation:

To Address Burst Compact luminaires, including switching between 8-bit mode and 16-bit mode, by downloading **QuickPlay Pro 2**.

Accessories

	Item Number	Item 12NC
14° Spread lens	120-000080-04	910503701415
23° Spread lens	120-000080-05	910503701416
41° Spread lens	120-000080-06	910503701417
10° x 41° Spread lens	120-000080-07	910503701418
Trim Ring, Black	120-000103-09	910503701823
Trim Ring, Gray	120-000103-03	910503701420
Trim Ring, White	120-000103-15	910503701826
45° Glare Shield, Black	120-000103-10	910503701824
45° Glare Shield, Gray	120-000103-04	910503701421
45° Glare Shield, White	120-000103-16	910503701827
Full Height Glare Shield, Black	120-000103-11	910503701825
Full Height Glare Shield, Gray	120-000103-05	910503701422
Full Height Glare Shield, White	120-000103-17	910503701828
Honeycomb Louver, Black	120-000104-01	910503701419
Mounting Arm, Short, Black	120-000201-00	912400135840
Mounting Arm, Short, Gray	120-000201-03	912400135843
Mounting Arm, Short, White	120-000201-06	912400135846
Mounting Arm, Medium, Black	120-000201-01	912400135841
Mounting Arm, Medium, Gray	120-000201-04	912400135844
Mounting Arm, Medium, White	120-000201-07	912400135847
Mounting Arm, Long, Black	120-000201-02	912400135842
Mounting Arm, Long, Gray	120-000201-05	912400135845
Mounting Arm, Long, White	120-000201-08	912400135848
Wiring Compartment, 4 in diameter, Black, CE (cover not included)	106-000011-40	910503703275
Wiring Compartment, 4 in diameter, Gray, CE (cover not included)	106-000011-42	910503703277
Wiring Compartment, 4 in diameter, White, CE (cover not included)	106-000011-41	910503703276
Wiring Compartment, 4 in diameter, Black, UL (cover not included)	106-000011-30	910503704147
Wiring Compartment, 4 in diameter, Gray, UL (cover not included)	106-000011-32	910503704149
Wiring Compartment, 4 in diameter, White, UL (cover not included)	106-000011-31	910503704148
Power Supplies		
Data Enabler Pro, 3/4 in / 1/2 in NPT (U.S. trade size conduit)	106-000004-00	910503701210
Data Enabler Pro, PG21/PG13 (metric size conduit)	106-000004-01	910503701211
DM-1000 0-10 V ELV Dimmer, UL	109-000036-00	912400135916

© 2021 Signify Holding. All rights reserved. The information provided herein is subject to change, without notice. Signify does not give any representation or warranty as to the accuracy or completeness of the information included herein and shall not be liable for any action in reliance thereon. The information presented in this document is not intended as any commercial offer and does not form part of any quotation or contract, unless otherwise agreed by Signify.

All trademarks are owned by Signify Holding or their respective owners.



www.colorkinetics.com